



# LANCASHIRE

VOL. 43

FEBRUARY 2021

No. 1



## THE LANCASHIRE FAMILY HISTORY & HERALDRY SOCIETY

Formerly Rossendale Society for Genealogy & Heraldry (Lancashire)  
Inaugurated 1973. Registered Charity Number 513437

President: Stephen J. Ward

Vice-Presidents: Rodney Hampson, Jim Topping, Terry Walsh,  
Tony Foster, Margaret Purcell,

Visit our Website on [www.lfhhs.org.uk](http://www.lfhhs.org.uk)

Subscriptions: Ordinary Membership	£14	Overseas Membership	£16
Family Membership	£15	UK Pensioners & Students	£12

Renewals are due on the 1st January. Cheques should be crossed and made payable to Lancashire Family History & Heraldry Society and sent to the Membership Secretary.

---

### MEETING VENUES

<b>BLACKBURN &amp; DARWEN</b>	Ewood Park Working Mens' Club, 318 Bolton Road, Blackburn BB2 4HY First Thursday of the month at 7.30 pm.
<b>BURY</b>	Blackburne Hall, Church House, The Wylde, Bury BL9 0LA Second Wednesday of the month at 7.30 pm.
<b>CHORLEY</b>	Cunliffe Hall (Chorley Masonic Hall), Cunliffe Street, Chorley PR7 2BE Third Thursday of the month doors open at 7.00 pm.
<b>FYLDE</b>	St. Martin's Church, Fleetwood Road South, Carleton, Poulton-le-Fylde FY6 7NL Second Wednesday of the month at 7.30 pm.
<b>HERALDRY GROUP</b>	LFHHS Resource Centre, 2 Straits, Oswaldtwistle, Accrington BB5 3LU First Monday of the month at 7.30 pm.
<b>HYNDBURN</b>	Accrington & District Blind Society, 32 Bank Street, Accrington BB5 1HP Second Thursday of the month – 7.15 pm for 7.30 pm
<b>IRISH ANCESTRY GROUP</b>	2 Straits, Oswaldtwistle BB5 3LU Saturday Workshops 1 pm – 4.30 pm as per Branch Programme.
<b>LANCASTER &amp; MORECAMBE</b>	Morecambe Heritage, Unit 29 Arndale Centre, Morecambe LA4 5DH Third Friday of the month – 12.00 noon – 2.00pm Drop-in sessions first Friday of the month 11.00am – 3.00pm
<b>LONDON &amp; SOUTH</b>	St. Stephens' Church Hall, 48 Emperors Gate, Kensington, London SW7 4HJ Five meetings a year on Saturdays at 2.00pm (see Branch Programmes)
<b>PENDLE &amp; BURNLEY</b>	Colne Library, Colne BB8 0AP Third Wednesday of the month at 7.30 pm.
<b>PRESTON</b>	Kingsfold Methodist Church, Padway, Penwortham, Preston PR1 9EJ Last Wednesday of the month at 7.30 pm.
<b>ROCHDALE</b>	St. Andrew's U.R. Church, Entwisle Road, Rochdale OL16 2HZ Last Wednesday of the month at 7.30 pm.
<b>ROSSENDALE</b>	Longholme Methodist Church (opp. Bus Stn) Bacup Road, Rawtenstall BB4 7NU First Wednesday of the month at 7.30 pm.

## CONTENTS

Page	2	Branch Programmes
	2	LFHHS Forum Guidelines
	8	LFHHS Members' Zoom Meetings Guidelines
	12	Society Virtual Meetings by Zoom 2021 – Marian Crossley
		Members' Articles –
	19	Stanworth Name Origin – Linda Stanworth Dinkel
	21	Is History Tucked into your Family Tree? – Liz Hedley
	27	Deaths Notified
	29	Book Reviews
	32	Notes and News
	36	Branch News
	42	Members' Interests

*Front Cover Picture:* Wallwork Family c1919  
from Albert Beckett

Jane Ann Wallwork nee Stanley 1879 - 1959, Annie Wallwork  
1909 – 1999 and Nora Wallwork 1913 – 1961  
9 Slack Fold, Slack Lane, Pendlebury

If you have a drawing or photo suitable for the front  
cover, kindly forward to the Editor. Thank you.

---

All contents of this magazine are copyright of Lancashire  
Family History and Heraldry Society and individual  
authors. No such content may be reproduced in any  
form unless prior permission to do so has been given by  
the Editor and the author/authors concerned.

**When sending items or articles for inclusion in the  
journal it is now necessary for you to give  
permission to print your e-mail or contact details.  
Thank you.**

# BRANCH PROGRAMMES

**Please note – at the time of going to press we are not aware of the date meetings are expected to resume. LFHHS website will advise when we know.**

## LFHHS MEMBERS FORUM – E-MAIL DISCUSSION GROUP – GUIDELINES

The Society has provided a members' e-mail discussion group called LFHHS Forum on Groups.io. This replaces the previous Yahoo! Group. The list is restricted to LFHHS members only and is Moderated. Members should note that their email address will be visible on the messages they post, enabling others to reply privately off list.

The screenshot shows the LFHHS Forum page on Groups.io. The page includes a navigation menu on the left with options like Home, Subscription, Admin, Messages, Hashtags, and New Topic. The main content area features the LFHHS logo, a description of the forum, group information (including website, members, and topics), group email addresses, and group settings. A white arrow points from the text above to the 'Group Information' section.

**LFHHS Forum** LFHHSForum@groups.io  
The LFHHS Forum replaces the previous Yahoo Groups Forum. It provides a space for chat, notifications, questions and answers relating to the Lancashire Family History & Heraldry Society

**Group Information**

- lfhhs.org.uk
- 131 Members
- 26 Topics, Last Post 14:18
- Started on Nov 20

**Group Email Addresses**

Post: LFHHSForum@groups.io  
Subscribe: LFHHSForum+subscribe@groups.io  
Unsubscribe: LFHHSForum+unsubscribe@groups.io  
Group Owner: LFHHSForum+owner@groups.io  
Help: LFHHSForum+help@groups.io

**Top Hashtags** (See All)  
No used hashtags.

**Message History**

Jan	Feb	Mar	Apr	May	Jun	Jul	Aug	Sep	Oct	Nov	Dec

Forum Guidelines.pdf...  
army\_application\_...  
20180524-request\_...  
Removed

15:16  
ENG UK  
16/12/2020

## **Joining without an initial invitation**

1. Go to the website at:  
<https://groups.io/g/LFHHSForum>
2. OR Download the 'Groups.io' App.
3. Click on Subscribe and complete the e-mail template that pops up.
4. You are required to have a current e-mail address, to receive e-mails from the Group at your usual address and you will need to set a password.
5. An email will open in your browser. Simply request to be a member and click 'Send'
6. You will receive an invitation from the Forum.

## **Joining with an invitation email**

7. In the email you receive, you will be asked to 'Accept the Invitation'.
8. Click on that link and that will establish your link to the Forum.

## **Once you have joined**

9. You will receive a standard 'Welcome Message'
10. You are now all set to go!
11. Your first two email messages to the Forum will be 'Moderated', that is checked for current membership and 'appropriateness' of the email message. After that, your messages will go immediately to the Forum.
12. You can see your messages on the web at  
<https://groups.io/g/LFHHSForum/topics>

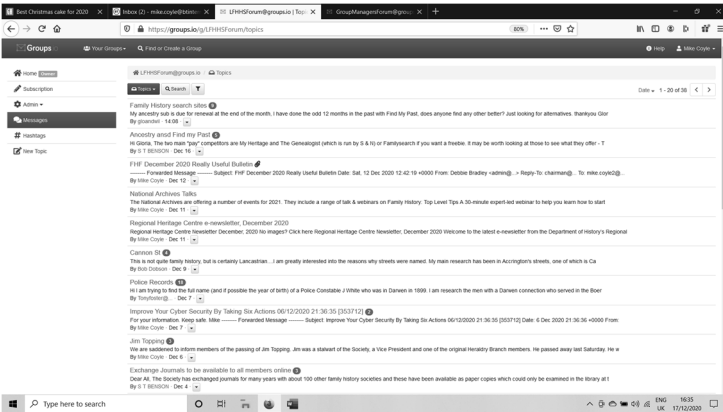

If you download the App and have created a Groups.io account, open the App. All the settings and preferences are set for you.

If you want to modify these in any way. Go to the 'Profile' at the top right of the page, you can change any of those items from the menu on the left. For example, you will be able to choose to receive all emails, a summary of emails or a digest; or change your email address.

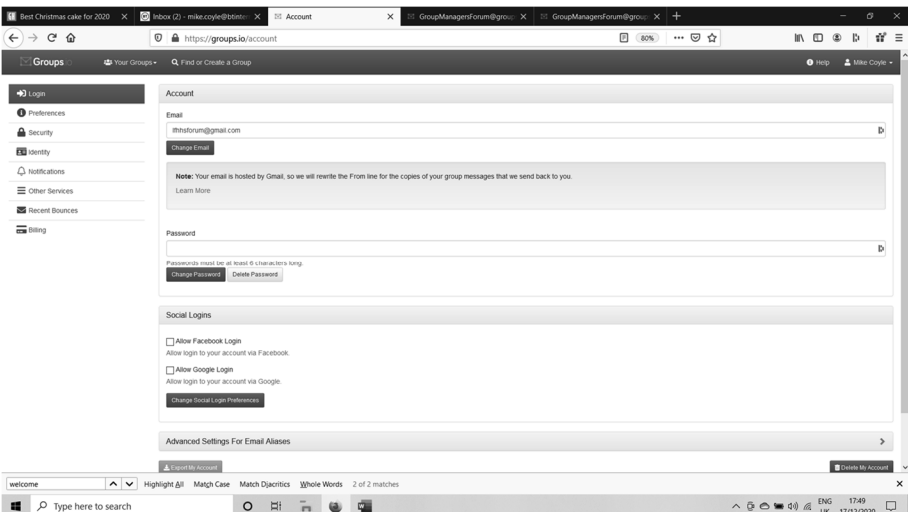

## **Leaving (unsubscribe)**

Members can leave the Group by sending an e-mail to:  
[LFFHSForum+unsubscribe@groups.io](mailto:LFFHSForum+unsubscribe@groups.io)

Note: If you are just going on holiday you can select an option in your personal settings on the website not to receive e-mails from the Group for the period you are away. When you return you can change the settings back. This saves you having to subscribe again.

## **Sending a message**

You can send a message from your normal email address to: [LFFHSForum@groups.io](mailto:LFFHSForum@groups.io)

Always sign off with your full name so that others can identify you, and, if you are making a request for information, your location so answers can be tailored to where you are. You can reply to a Group message in the normal way by using your email 'Reply' function.

NB. As you no doubt appreciate, websites are subject to change and these instructions are current as at December 2020. If you encounter any difficulties with your registration please do not hesitate to contact the LFHHS Group Moderator, by emailing [<LFFHSForum+owner@groups.io>](mailto:<LFFHSForum+owner@groups.io>).

## **Sending attachments**

There is a self-imposed limit on the size of an attachment of 500kb, but please keep them small. If attaching images, make sure they are Low resolution. Where files are larger than 500kb, Groups.io provides a link to the file.

## **User Hints**

### **Subject Lines**

The subject line should be sufficient to grab the attention of the reader. This will enable them to open the message as potentially interesting or binning the message as unlikely to be of interest.

Subject lines such as "Family History" or "Help" are not good subject lines. A subject line of "SMITH, Chorley, c1850" will attract those who have an interest in that name and place and the message can be safely rejected by those with no interest.

When replying to a message, but changing the topic, please change the subject line to one that is relevant to your message.

### **Asking for help**

When asking for help/advice it would be helpful if your location, e.g., county/country could be mentioned. A member in the locality of the source of information, e.g., local library, will get a different response to those living overseas or the far corners of the UK.

### **Off-topic Messages**

Only subjects that are "on-topic" should be posted to the Forum; i.e., they are about Genealogy or Family History. Messages that are "off-topic" should not be posted to this mailing list, or they may be rejected.



If a topic starts to drift the mailbox moderator will ask for a halt on the topic. Please do not send "Test messages" to the list. Think about the effect with every member on the list getting a message which has no relevance to anyone. If you have something of interest to post, then post that.

## **Replying to messages**

When replying, it is sometimes useful to retain a part of the original message so that other readers can understand the significance of what you are saying. However, please delete what is not relevant and don't allow long strings to develop in individual e-mails. The strings can be viewed on the Group website.

If the topic might be of general interest, please reply to the list as it is likely that others are interested and, more to the point, it will inform others who can provide advice that the query has been dealt with.

## **Things you may regret saying**

Some messages may irritate, although that was not the intention by the writer. The list should not be used for personal criticism or insinuation which may be regretted later. Your email may be rejected.

Mike Coyle  
Group Moderator

---

# **LFHHS MEMBERS ZOOM MEETINGS - GUIDELINES**

Zoom enables us to hold and make available, meeting space for formal and informal meetings, live or recorded talks and presentations.

The Society has provided a members' Zoom meeting facility called 'LFHHSZoom' available via your web browser, using a desktop, laptop, tablet or smart phone. Formal presentations can be watched without the facility of a camera, but you will need a speaker, which are standard with a laptop, tablet or smart phone. To participate in a meeting, you will need a microphone; usually built into a tablet and smart phone. Where participants use a desktop without speakers they can join by phone for use of speaker and microphone.

## **Accessing Zoom Presentations**

Zoom Meetings are restricted to LFHHS members only, at the moment, but it is hoped that we can open the space to non-members for talks and presentations, at a cost to them.

### **Joining via your Browser**

When a talk is planned, members will receive an email that gives the following details:

- The date and time of the meeting
- A link to click to join the meeting, when you click on it, you will be taken to the web page where the meeting will be screened.
- A Meeting ID, For example: 220 102 7322

- A 'Passcode', use it like a password to get access to the meeting.

Click on the Link; you receive this screen, or one like it; put in the '**Passcode**'; then '**Join Meeting**'

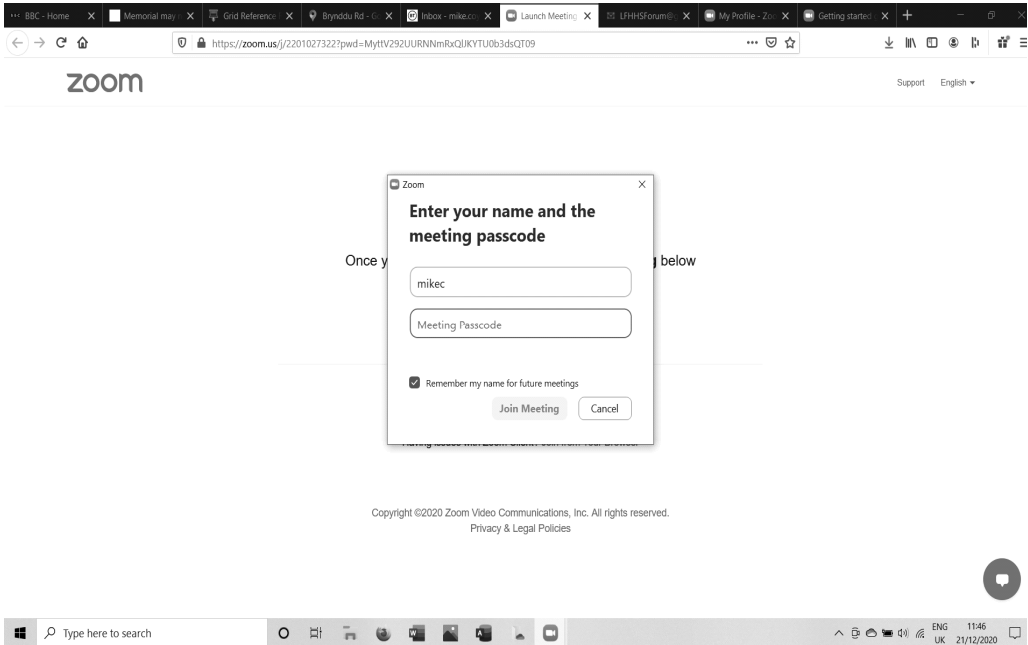

## Joining via the downloaded Zoom App

For those who are joining Zoom for the first time you may be invited to download the Zoom App. This is the preferred way of joining Zoom meetings.

- Open the App

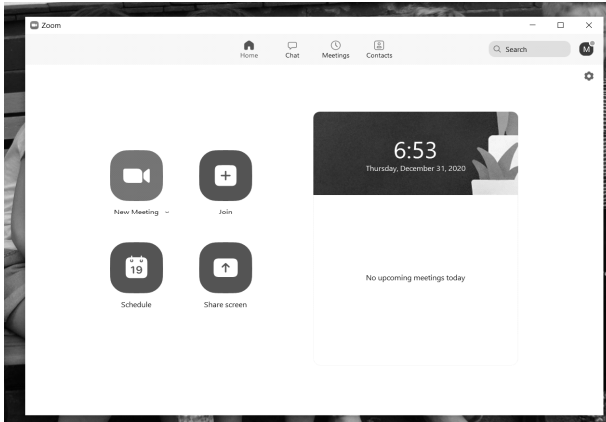

- Click on the 'Join' button



Join

- Enter the 'Meeting ID' from the initial email invitation. Then 'Join'

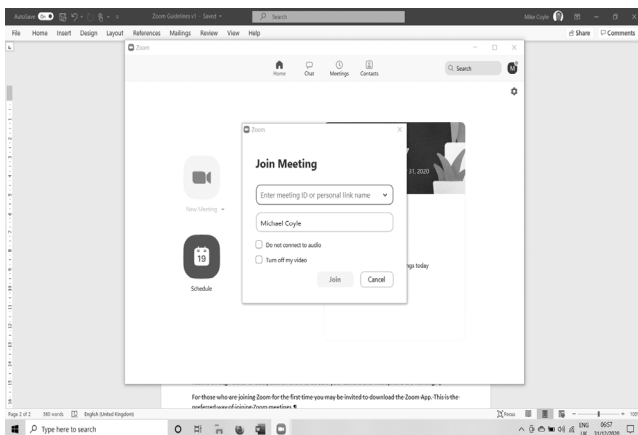

Clicking on the link will enable you to join the meeting.

- Select if you would like to connect audio and/or video and click '**Join**'. On the lower left of the screen there is a small icon for the Camera and Microphone, if there is a redline through either or both, click on them to be sure your camera and microphone are working.

## **Having joined a Zoom Presentation**

- Once you join a formal presentation, please 'Mute' yourself if the Host hasn't already muted everyone. If you wish to contribute you will need to unmute yourself.
- A 'Chat' facility is available for you to pass a message to the Host and other members who have joined the meeting, without interfering with the presentation.
- Presentation copyright remains with the Presenter and you must not record presentations without expressed permission of the Presenter.
- Because you are joining the presentation voluntarily, it is assumed that you give permission for camera and microphone access to you, your home surroundings and your contact details.

## **More help**

There is a short video to help you join a meeting at:  
<https://support.zoom.us/hc/en-us/articles/201362193>

You may also organise a meeting by simply requesting one with dates and times and subject title and email it to: [lfhhszoom@btinternet.com](mailto:lfhhszoom@btinternet.com)

Mike Coyle

---

## **SOCIETY VIRTUAL MEETINGS BY ZOOM 2021**

**Updated 9 January 2021**

**Contact: Marian Crossley  
e-mail: [mariancrossley74@gmail.com](mailto:mariancrossley74@gmail.com)  
for more information.**

**As we are not getting any nearer to the idea that we will be able to meet up again as Branches, the Society will be offering its members a series of online monthly talks using Zoom.**

**The talks will take place at 7pm on the second Tuesday of the month, and as it is online we are not restricted to who we can ask to give us a presentation. This means that hopefully the subject matter can be something quite different and we can have speakers from all over the UK and even the world if the subject is one of interest to you, our members.**

**After all this time in lockdown a large number of us have already participated in Zoom Meetings. If you**

haven't and are not very 'technical' don't worry, it is easy once you know how. First download the Zoom application onto your computer / laptop / phone / iPad and then search for a You Tube / guidance on how to join a meeting. For ease I have put a link below, but there are plenty of places online you can go for advice.

<https://support.zoom.us/hc/en-us/articles/201362193-joining-a-meeting#:~:text=Go%20to%20join.zoom.us,client%20to%20join%20the%20meeting>.

Our own Mike Coyle has also produced a 'guide' for members, printed before this article.

Keep checking LFHHS website 'Society Virtual Branch' for up-to-date information, as further speakers are arranged.

**Tuesday 9 February 2021**

**Sarah Lee**

**The Bragg Family of West Cumbria –**

The Bragg family were seafarers and the family story includes two murder trials one at the Admiralty Courts, one at the Old Bailey; both were found not guilty, however one was later thrown overboard by his crew half way between New Zealand and Van Dieman's land, this third murder trial was held in Australia. There was also romance on the high seas,

**shipwrecks and cannibalism. A later generation won a Nobel Prize too!**

**Could you please start joining the meeting from 6.45pm onwards to ensure that we are able to start at 7pm**

**Topic: LFHHS Online Talks**

**Join Zoom Meeting**

**<https://us02web.zoom.us/j/83772293722?pwd=bXBHb001MzBXaUxtL2R2R1lxNHMrdz09>**

**Meeting ID: 837 7229 3722**

**Passcode: 363163**

**Tuesday 9 March 2021**

**Eric Jackson**

**After you are dead –**

**This talk tells of the rise and history of anatomical dissection, its use as a punishment and how the ever-growing need for bodies led to grave robbing to feed the need for bodies to be used by the anatomists.**

**Could you please start joining the meeting from 6.45pm onwards to ensure that we are able to start at 7pm**

**Topic: LFHHS Online Talks**

**Join Zoom Meeting**



<https://us02web.zoom.us/j/83863113859?pwd=U3RqYXYrNmITZ2JtMVhic2VhK3RkUT09>

**Meeting ID: 838 6311 3859**

**Passcode: 702391**

**Please note that we are, of course, still looking for 'willing volunteers' to give talks.**

**This invitation is open to all members, worldwide.**

**Training, advice and support will of course be given.**

**If you have a suitable 'talk' but do not feel you could deliver the talk yourself, send your contribution, in writing, to Marian who will arrange for it to be read out on your behalf.**

---

**LANCASHIRE FAMILY HISTORY &  
HERALDRY SOCIETY  
AGM 2021**

**It has been agreed that the 2021 Society AGM will go ahead via Zoom at 2pm on Saturday 15<sup>th</sup> May, without any Conference.**

**An AGM invite will be sent to all paid up members of the LFHHS in early May.**

**Matters for inclusion can be sent to:  
Chairman@lfhhs.org.uk at any time before  
1<sup>st</sup> May 2021.**

**We expect to hold the Conference later in  
the year hopefully “face to face” but it may  
also need to be via Zoom, depending on the  
situation with Covid 19 and associated  
spacing restrictions.**

**Sheila Court, Management Chair, LFHHS**

---

## **CHANGES TO “LANCASHIRE” ELECTRONIC JOURNAL ARRANGEMENTS**

In the past we have sent out an e-mail for each issue advising all signed up members requiring the electronic journal of the weblink to download it from.

In future instead of doing that, we shall be making the journal available in the Members Area and at the same time putting a notice on the website and on the forum as soon as the journal becomes available. All you need to do is go into the Members’ Area, select Members Downloads then scroll down to the latest issue. You can

either read it online or download a copy to your computer or tablet and read it at your leisure.

In addition, the exchange journals with other societies, which only used to be available at Oswaldtwistle, from January this year will be held digitally online and can be read in the Members' Area or downloaded to your PC. This is becoming the norm between Societies.

---

### **RAMBLINGS FROM THE EDITOR**

What a horrible start to 2021. Little did anyone expect Covid 19 to be so pandemic after almost a year. Not many of us are able to say we have not lost relatives and friends to it.

For Society members who have renewed for this year we are working hard to ensure that we are offering Zoom meetings while we are not allowed "face to face" meetings. A bonus for members who have not been able to attend local meetings. Some branches are also looking into putting their own talks on the Society website. Keep checking to see what is available and for how long.

Even Lancashire Archives who have had to close again, are still busy at work, and are putting their monthly lunchtime talks via Zoom, making them available to a wider audience. Their phonedlines are still working, and if you have a query, or want any photocopies, they are all there to help.

Have you had a look through our Society website to see what publications are available for sale? All orders are being processed by one volunteer because of the restrictions imposed at the moment.

Thank you to members' who have sent me articles for publication in the journal. Always much appreciated, after all it is your Society and it is always impressive to read what other members have managed to research, and especially to learn what resources they used, and where they can be found. Remember, as a Charity, our main aim is to promote family history, and to assist our newer members with their quest. So many people new to family history do not join a Family History Society as they are under the impression that everything can be found via the internet! Wrong! Pre computers we all spent hours or days in libraries or record offices ploughing through records and bmd registers.

Keep up with your research and listen to our increasing Zoom meetings. Good Luck and Stay Safe.

---

## **MEMBERS' ARTICLES**

### **STANWORTH NAME ORIGIN**

By Linda Stanworth Dinkel, 458 Benevente Drive,  
Oceanside, CA 92057 California  
E-mail: iris1213@sbcglobal.net

I wish to inform those at the Lancashire Family History and Heraldry Society of a significant find I have made concerning the origin of the surname Stanworth, also my maiden name. I have been helping my cousin Ben Stanworth learn how to

research his genealogy. Although I am not a credentialed genealogist, I have fifty years of work under my belt and have been given the responsibility of continuing the research on mine and my husband's lines from great genealogists who came before us. I learned what I know from doing it the "hard way" before the computer and early, informative workshops when available. I have also helped several individuals find their birth parents due to adoption or estrangement.

I wanted to tell the society of my find as soon as I could get a bit more clarity from the place where I found the name because the book is in Latin. So far I have not been able to locate a translated version of the book. However, I can clearly tell what is being written where I discovered the Stanworth surname. Because Ben has already mentioned to you what I have found I must tell you where I'm at right now. As it is such an important find I wanted to wait until I had it altogether and present it all to you and other societies here in America so it is clear who made the discovery and how.

In 2010 I was able to get my Stanworth line back to a Roger de Stanworthe, 1200 AD, of Walley, Lancashire, England with a wife's last name only, de Withnell (Wythnell). Not until now, November 2019, did I ever find anything else. Finding the wife's father's name, William de Withnell, I decided he had to be the key because every single record, story, book and document I kept coming across was thick with Withnell importance and history in the Lancashire area. That led me to the Coucher Book of Charters and how land, abbeys etc. were obtained by the notable names of the time. I took that route to see if it would mention anything connecting to Roger de Stanworthe. I located an available, online printing of a book entitled, "The Coucher Book Or Chartulary of Whalley Abby, Vol. III" edited by W. A. Hulton, Esq. Printed for The Cheetham Society, M.D.CCC.XLVIII.

Source: <http://grimshaworigin.org/wordpress/wp-content/uploads/CoucherBookWhalleyV3.pdf>

I found the above book by going to the following website and choosing Vol III; The Coucher Book of Whalley – Grimshaw

Origins and History. It is in Latin except for the Contents in the beginning of the book and a few short, explanation excerpts in English throughout the book. Not being able to read or understand Latin I tried using an online translation site for key words I was seeing. I got the gist of some words and found the following:

Read middle of page 831, a succession of pedigree names.  
Look for line

"The second daughter married Roger de Stanword, living temp. John (No.1), who had a son,  
Adam de Stanword, (No.3), who had a son,  
Richard de Stanword (No.4), lived circa 1240"

These are the names I have on my personal pedigree chart except the last name is spelled de Stanworthe! See 'living temp.' I don't know what it's abbreviated for but could it be Templar?

By beginning on page 830 under the first paragraph about the land area known as Stanworth I can only figure out part of what is written with my Spanish background. But it is clear when you see the names it is my family's Roger then called Rogeri de Stanword and on page 853 (bottom) Rogerus de Stanword. When you come across the word "villam" it means country house, farmstead. Look through pages 830-876.

(Editor: It has not been possible to publish copies of these pages, but they can be e-mailed to interested members, especially those who can read Latin).

The dates go way back. Stanworth was originally Stanword. To drive the information home to when it headed in the direction of Stanworth for the proof is on page 837, XI.Stanworth (Yes, STANWORTH) you finally see my surname. No wonder no one could go further. We now must look for Stanword to search the Stanworth line going further back. Equally important is finding which country the Stanword line immigrated from prior to going to Britannia. Given more time I have hopes that there may be just one word in the Latin

translation of the Coucher Book mentioning where they were before being given land in Britannia.

I consider it the most significant breakthrough in a lifetime and I am sure there are no genealogists alive who know this connection of our name. No one at any historical society or anyone I have come across in the research world of genealogy has been able to tell me this direction our last name went ... NO ONE! Very exciting.

---

## **IS HISTORY TUCKED INTO YOUR FAMILY TREE?**

By Liz Hedley

5 Birchfield, Much Hoole, Preston. Lancs PR4 4HD

My cousin Eleanor Morton (Nell) Johnson died on 14 May 2001 (aged 85). My brother, who was sorting out her affairs, on the way to the Lake District, brought me three boxes. *"You've got the weekend to look at these and then I have to take them down south again and give them to the Bagleys"*. I dropped everything and frantically wrote and copied as many details as possible and found it riveting. I knew Nell's father had inherited a top job at his family run business because of the loss of the oldest brother in the 2<sup>nd</sup> World War and that she was an only child and that she never married but had no idea what the business was. (Amongst her many attributes Nell was made a *"Freeman of the Worshipful Company of Tinsplate Workers alias Wire Workers"*).

In a letter dated 31<sup>st</sup> May 1946 to Michael A. Johnson, Nell's father Arthur Lawrence Johnson (b. 13.5.1887) tells of how he is giving *"a silver Table Centre and Bon Bon dishes (presented to my grandfather William Johnson on 28<sup>th</sup> January 1859) to the Worshipful Company of Tinsplate Workers alias Wire Workers, to commemorate my own Mastership in 1941/42 & 43"*. A list of company names (1773 to 1895), and a synopsis of what the company did (signed by George Foulkes, Ironmaster & Wiremaster, Head of Dept.) takes us to the last

entry on the list:- 10<sup>th</sup> July 1895 – “*Visit by The Rt. Hon. A. J. Balfour & Miss Balfour*”.

Papers, family photo albums, letters and loose photos included Log Books for a sea-going steam yacht, S.Y. “*Cara Mara*” (sorry, never thought to write down the dimensions but I copied a photo of it) – used for yachting trips (1897 – 1904), up the Western Isles, Shetland, cruises to Norway, Sweden, the Scilly Isles, the Great Orme, Menai Straits, Calais, Ostend – ending with the Baltic coast (1904) – where they visited a firm in Stockholm that made machine tools – (and from where the mother travelled back to England by train because she had a bad foot!) On that cruise they also visited two companies in Copenhagen. They took relatives and friends to Reviews and Regattas – Oban, round the Fleet at Cowes, (1902) – Calais (1903), Coronation Review, Fleet Reviews etc. The second son, Alan D. Johnson (who lived at Christ Church Vicarage, Ashton-u-Lyne) took Sunday services on board as well as in churches up the coast). On one Review trip they had to have two dinner servings because of so many on board – each cruise listed all the names of those who came on board.

It was Arthur Lawrence Johnson, third son, who married one of my grandmother’s sisters, Eleanor Belk, on 10<sup>th</sup> March 1915 at St. Barnabas Church, Middlesboro. Arthur was one of four Johnson boys (no mention is made of who the 4<sup>th</sup> son was but it says there were 4 sons and 3 daughters – twin girls were the first-born). He also had 3 sisters, the youngest of whom, Lorna A. Johnson, married 2<sup>nd</sup> Lt. Charles H. F. Bagley on 10<sup>th</sup> December 1915 – hence the present-day remaining relatives. Arthur’s father, William Henry Johnson, of “*Messrs. Richard Johnson, Clapham & Morris*” (staff and workers – just under 400), and his wife Agnes Morton, from 1883 brought up their family at Woodleigh, Dunham Massey, Altrincham. The Firm made copper wiring, nuts and bolts – described as Pin and Wire Drawers & Smallware Manufacturers – based at Moston – which I am told is now Trafford Park. Arthur Lawrence Johnson (b. 18.5.1887) started work at the Firm on Saturday 8<sup>th</sup> January 1910 and by Monday 10<sup>th</sup> January his diary records that he is



*"v. sick of my job."* Peter Denny tells him he is *"a cut above all the other apprentices there ..."* and *"expects I find it a change from Cambridge"*. By the end of the week – Friday 14<sup>th</sup> March 1910, he writes *"... got shift after made 1487 nuts, 1291<sup>3</sup>/<sub>4</sub>" and 1196<sup>5</sup>/<sub>8</sub> nuts and am now at a surface table ... work here very interesting as we have all the drawings and set out the work for all the shop ... this is something like a good job ... have begun to coach A.... will teach him something I hope ... thank goodness tomorrow is Sat ... wonder what my remuneration is ... FINE!!"* His father died in February 1914. His elder brother William Morton Johnson then became head of the firm. It was to be short-lived. Captain William Morton Johnson, 16<sup>th</sup> Manchester Regiment (b. 2 September 1881) was killed in France in action at dawn on 2<sup>nd</sup> July 1916. Arthur Lawrence stepped into his place.

The business all began in 1773 with James Howard at 72 Market Sted Lane. He was a Pinmaker, wire worker and wire weaver. He progressed to be at School Mills, 22 Long Millgate (House in same street) and then became James Howard & Son & Co.- and so it goes on – till 1813 – Howard and Russell, 1818 Johnson & Sharrocks (Pin & Flour Machine Manufacturers), then it was Wire Mill in Edge Street, Shudehill (this Mill fell in and nearly killed some of the hands). In 1838 – Richard Johnson & Bros., the 1860s – Richard & William Johnson (but William died in 1960 aged 49); in 1864 it was Richard Johnson & Nephew (John Thewlis Johnson, son of Thomas Johnson, Cotton Spinner of Bolton, & Manchester, & grandson of afore-mentioned John Johnson). In 1881 Richard Johnson & Nephew – John Thewlis Johnson & James Clarkson Johnson, brothers are listed. (James Clarkson Johnson died in 1890 – also at age 49). From 1890 to 1896 it was all these Johnson's (sons, brothers, nephews) with the last entry on my sheets – for 1896 – Johnson & Nephew – Herbert Alfred Johnson & Ernest Johnson. It somehow then became Messrs. Johnson, Clapham & Morris.

That is the background of the Firm and its business – here in two parts is what interests me:-

**= FIRST- Re: the Firm – (I have picked out only what seem important historical facts):-**

= in 1850 – they “were drawing wire for the first submarine cable – Dover to Calais”;

= in 1853/4 – they “commenced manufacture of iron – rolled Merchant Iron in lengths”;

= in 1854 – “wire was drawn for the Niagara Railway Suspension Bridge” – “it was packed loose in casks, each cask holding about a ton, & sent to Messrs. Roebling’s of Trenton, New Jersey, U.S.A.”;

= in 1857 – they “commenced to draw wire for the first Atlantic Cable – night & day for months, - 16-hour shifts”;

= 5<sup>th</sup> August 1857 – “expedition sailed with the cable from Valentia: cable was less than  $\frac{3}{4}$ ” in diameter & weighed less than a ton per mile. It was so flexible as to allow coiling in extremely small curves without injury”; [The first half of the Cable was laid in 1857 (first laid in 1857 (first Atlantic Cable) and the second half, in 1858, but not successful – so second attempt made in 1865/6]

= Mar, Apr, 1858 – “large order for No.5 galvanised Puddle Wire for India Office”;

= in 1859 – “the Red Sea Cable order”;

= in 1861 – “drawing No.9 for Tillotsons, New York (all work stopped suddenly due to the American Civil War)”

= 16<sup>th</sup> September 1871 – “+ engine-powered (previously wound by hand)”;

= in 1876 – “two Americans came over, from Washburn & Meons (Worcester, Mass) to teach those at Ambergate to draw wire after the American fashion, viz. through cast dies (it had been tried in Yorkshire, & Birmingham, & also themselves – but not succeeded). (in two years they were able to execute orders on their own account.)”

= in 1877 – “Patent wire – machine for Barb Wire fencing”;

= in 1878 – “Ambergate works closed – depression of trade (41 drawers plus many other hands); and then another strike”;

= in 1879 – “some were recruited to go to the U.S.A. – the first reduction of wire drawers in Lancashire; now drawing No.6 b.w. 9 – Puddle Wire for the Telegraph Construction & Maintenance

Co. (Our firm held the Patent in this country). (On expiration of the Patent, & others making it – our work fell off.)”

= “after Mr. Bedson’s visits to America – he introduced anew coating for wire – salt (boiled). They found a substitute: gum, flour & lime, & eventually as gum was expensive, just flour & lime – which is still used today.”

= in 1882 – “manufacture of Charcoal Iron stopped”;

= in 1888 – “new Annealing House erected on old one – plus Mill”;

= in 1890, 4<sup>th</sup> March – “(Mr. Clarkson Johnson died)”;

= 1893 – Colliers’ strike – terminated a lot of work; during coal strike we bought No.6 German rods exclusively – soft & ductile – amazed at the drawing capacity of the wire – without annealing; the German rods created a revolution;

These were some of the notations on the list –

Signed by: George Foulkes, Ironmaster & Wiremaster  
(Head of Department – in 1895)

= **SECOND – Re: the Artist** – (George French Angas – eldest son of George Fife Angas, British merchant-settler who is remembered as the “father & founder of South Australia);

= Go back to 1864 – the Richard and William Johnson – it is this William Johnson (Arthur Lawrence’s grandfather) who married Emma Angas, youngest daughter of George Fife Angas of Newcastle & South Australia. I don’t know how many children they had – but Emma had a brother – George French Angas, a celebrated pioneer artist of the Aborigines of Australia and New Zealand.

= As a boy, George French Angas, impressed his elders with his great interest in natural history, and his ability to draw the subjects which interested him;

= Still in his teens he travelled in the Mediterranean and published his first work – “A Ramble in Malta and Sicily” – illustrated with his own sketches;

= He first went to South Australia in 1843 at the age of 20 – travelled extensively – and then spent three months in New Zealand, sketching and painting the Maoris;

= in 1847 – he issued “South Australian Illustrations” – and wrote about “preserving true & lifelike records of the men and

scenes now so quickly passing away” and how he has “devoted myself wholly to this work, visiting the remote parts of the colony and acquainting myself with the manners and habits of the native tribes”.

= His sketches were made at Port Lincoln, Encounter Bay, lakes Alexandrina and Albert, Mount Gambier, Mount Schank, Rapid Bay, and Noarlunga.

= in New Zealand he faithfully portrayed “ ... *habits, costumes, and works of art, though so rapidly disappearing before the progress of Christianity and Civilisation ... and have succeeded in obtaining portraits of the most important Chiefs, with their families, and have made drawings on the spot of all objects of interest connected with history.*”

= in 1847 he returned to England, held an Exhibition of his work, and married (no name) and returned to South Australia;

= When he arrived the Gold Fever was at its height and he made sketches – of the Ophir Goldfields and the Barossa Valley;

= in 1853 he settled in Sydney and became Secretary to the Australian Museum;

= in 1861 he returned to England. In later years he became an authority on sea-shells – corresponding and collecting widely, and publishing many articles on them;

= Sociologists, ethnologists, and anthropologists now consult his paintings, lithographs and sketches for detail of Australian and Maori artefacts, face and body markings, customs, weapons, ceremonial dress, and trappings. (Scientists have checked – and find he is completely accurate in every detail.)

= 150 of his paintings were handed over on behalf of his father’s Will Trust, to the Museum, by Mr. James Angas Johnson, whose mother was a sister of the artist, in March 1968 (so said: Marjorie M. Johnson, in a hand-written note on the 2-page newspaper cutting from the South Australian Sunday “Mail” of 22<sup>nd</sup> March 1968 – her address – 8 Fitzroy Terrace, Prospect, South Australia).

There was so much of interest in those three boxes about the Johnson family. I confess to say that I have not researched any of it. The tragedy of those lost in war – and perhaps thoughts of what might have been if they had not been lost –

sometimes means celebratory parts of one's family tree – go un-discussed and un-rewarded. I just find it fascinating that it was all lying in Nell's house at Stewkely, in her busy world of horses, dogs, and country life – unearthed and un-discussed – and yet to me so much of it is part of our social history – and – important – and – needs to be remembered.

---

### **DEATHS NOTIFIED**

**James Topping** – Vice President  
**Brian Pearson** – Pendle and Burnley  
**Mrs A Shirley Cormack** – North Yorks  
**Mrs Jackie Moore** - Fylde  
**Mavis Murphy** – Blackburn  
**Frank Millward** - Nantwich

*Our thoughts and prayers go out to the families of the above.*

### **JIM TOPPING 1930-2020**

We are saddened to inform members of the passing of Jim Topping. Jim was a stalwart of the Society, a Vice President, former Society Treasurer, and one of the original Heraldry branch members.

Jim passed away at the beginning of December at the age of 90 years, but sadly had been in a home for 10 years. He died of the implications of vascular dementia. Yet another victim of a small family funeral because of the Covid 19 pandemic.

Many long-standing Society members remember Jim with fondness:

Tony Foster – When I joined the committee he was the treasurer and ensured that the pennies were carefully spent, so much so, that he would try all the scales in the post office to ensure that he found the best one to use!

Steve Benson – I knew Jim for about 2 or 3 years when he regularly attended Heraldry meetings in a wheelchair, accompanied by his good friend and carer Mariam.

Olive Thexton – When I was a newish member, I remember well that I had to go to Jim's house. There were journals all over the place, being put into envelopes ready to be taken to the post. Our branch had to move out of the Hall and hold meetings in the Church on the Tuesday before the usual Wednesday meeting day. Once I had not put the correct information into our branch news and I typed out a note, cut the page into little slips and we had to put one into every journal. I thought that this was a huge job to complete, good job it was only a handful of times per year.

I would like to send thoughts and best wishes to the family. We always say that we are all part of one big family due to the family history research that unites us.

Margaret Purcell – I remember Jim from years ago when I first joined the Society, and used to go to the Preston meetings – also attended by some of the Heraldry people. This was before Fylde branch started.

Hazel Johnson – All those many years ago when I first joined the Society I attended the Preston meetings. Not only was Jim the Society Treasurer, but also Treasurer for Preston branch. I got involved with the journal packers when Mariam's house was used, before we acquired premises in Oswaldtwistle, where we had more space, but we had to listen to Jim and Derrick Walkden counting the correct number of journals to go into each box prior to going to the Post Office. If they didn't agree on the number in a box, it was emptied and they would start again, with all the different postage charges for different

countries. Next, they would start working out the cost for each box, and yet again if they didn't agree they would start all over again. They would never use calculators!

Regularly at Executive meetings we would have to remind Jim to either switch his hearing aid on or turn the volume up so he knew where we were up to. At one AGM held in UCLAN, Jim was sat behind Mariam, Mavis and Me and during what he must have thought was a boring talk, we had to nudge him to stop him snoring!

Always a genuine, helpful, lovely man. So much family history and heraldry information lost.

---

## **BOOK REVIEWS ETC**

**Books for review in the journal should be sent to:**

**Ian White, 23 School Fold, Hesketh Bank, West Lancs PR4 6RE or [ian.white4@live.co.uk](mailto:ian.white4@live.co.uk)**

**Have you had a book published and would like a review in the Society journal? Simply forward a copy to Ian White, address as above.**

**If you have reviewed a book you have read and think it would interest some of our members, you may simply forward the review to Hazel Johnson, [editor@lfhhs.org.uk](mailto:editor@lfhhs.org.uk) or [hazel.johnson2@btopenworld.com](mailto:hazel.johnson2@btopenworld.com) as usual.**

**Thank you.**

---

## HOGARTH'S PROGRESS

By John Hogarth, Member No. 3495

Always aspiring, as a long-term researcher myself, to achieve a permanent record of my family's history, I was delighted to receive the generous gift of his autobiography from John Hogarth, a member of this society, 3495, entitled 'Hogarth's Progress.' Written with skill, dedication and humour, combining a natural talent for portraying the history of his life and family, with many personal photographs, he has achieved the aim of just about every family historian I know.

He states "In the world as we know it, and with our finite minds, the only certainties are life, death, and history, and history is a record of life. Whilst there is some tangible evidence such as buildings and documents, only a snapshot is recorded. The rest exists in memory which disappears on death. The story of families goes some way towards filling the gap which is the object of my records and writings."

How better to describe our existence, most of us researchers would agree, that usually when it is too late, we resort to wishing we had tackled our departed intimate relations for information, to acquire what we need minimally from public records, many of the family events have died with them. There are many reasons for writing your autobiography, a personal record of one's life events, family involvement, regrets and experiences, and ultimately recollections of history. The interpretation of other members of the family is also very useful for future reviewers as is the delving into the historic family trees of yesteryear.

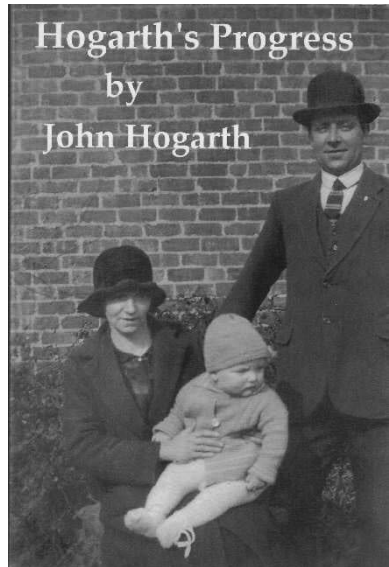



There are several ways to self-publish, much advice is available on the internet, Amazon have a guide to publishing in a Kindle or Paperback Book format as well as Lulu, Creatspace, Grosvenor House etc., etc. Starting from fresh with a MS Word programme will assist greatly, adding photographs, statistics, family trees and indexing are all summarised for beginners, software packages and graphics can be combined as can indexing of names places and historic events etc., all ways of maximising the availability of content.

Biographies and autobiographies are very interesting to many people, doesn't have to be a celebrity or even a so called 'minor celeb,' there is a remarkable attraction to any individuals life and times as I have found out enjoying my hobby as book reviewer for Cumbria and Lancashire family history societies and others, everybody has a tale to tell! Have a go, its great fun unravelling history!

Much as the book is an interesting read, it is unfortunately a private publication printed in the USA, but it does have an ISBN number, 9 781984 092571.

There is a website [https://www.justbooks.co.uk/isbn\\_search](https://www.justbooks.co.uk/isbn_search) where a simple search can, in fact, find the book and where to buy it. This is a valuable resource I have just discovered.

Reviewed by Ian White  
Treasurer

---

### **PEN & SWORD MARKETING**

E-mail: [psmarketing@pen-and-sword.co.uk](mailto:psmarketing@pen-and-sword.co.uk)

Just a few more book titles available from Pen & Sword:

- The Castle in the Wars of the Roses (Hardback)
- Richard III in the North (Hardback)
- The Forgotten Slave Trade (Hardback)

- The Spanish Flu Epidemic and its influence on History (Paperback)
  - Fashion and Family History (Paperback)
- 

### **ALAN GODFREY MAPS**

Prospect Business Park, Leadgate, Consett DB8 7PW

Tel: 01207 582233

Two new maps that may interest members: Published by Alan Godfrey Maps. The maps are 15 inches to the mile and are priced at £4.00 each. Highly detailed and an asset to family historians.

Lancashire: Manchester 111.02 Whalley Range 1892

This map joins a select group of four versions, giving excellent coverage of the changes across the years. This 1892 version is colour printed, taken from the 1<sup>st</sup> edition OS hand coloured map, and shows Whalley Range as development began, but still with five farms. The introduction is by Chris Makepeace.

Lancashire: Manchester 111.13 Baguley 1935

A second map was recently issued for Northenden, and now, next door, the same for Baguley, an area that was changing rapidly in the 1930s. The introduction is by Chris Makepeace.

---

## **NOTES AND NEWS**

### **LANCASHIRE ARCHIVES ONLINE TALKS 2021**

All talks will take place thanks to **The Friends of Lancashire Archives** and via **Zoom**.

*Last orders please!* – researching pubs and publican ancestors  
– Keri Nicholson  
Friday 22 January 2021 12.30 – 13.30

*Going underground* – our Lancashire coal mining ancestors –  
David Tilsley  
Friday 19 February 2021 12.30 – 13.30

*Memories Public and Private* – scrapbooks and commonplace  
books – Kathryn Newman  
Friday 19 March 12.30 – 13.30

**To book and receive a link please e-mail  
archives@lancashire.gov.uk**

---

## **BOB DOBSON – LANDY PUBLISHING**

Our long-time member Bob Dobson has been a second-hand bookseller specialising in Lancashire and Cheshire interest books for over fifty years. As boxfuls of books are getting heavier, and as some of his books are kept in a former hay-loft accessed by climbing a ladder, he has decided to 'sell up' and dispose of his stock. Our committee have come to an agreement with Bob that we will advertise his plans to the membership and accept his offer of paying 10% of the value of any invoices sent with books ordered to the society.

Bob does not have his own website and has recently left an internet-based site, leaving most of his trading being done by sending out his catalogues (one for each county) to those on his mailing list. If you would like to be added to this list, drop Bob a few lines requesting to see his catalogue(s). If you do order from it/them, and add that you are a member of the LFHHS, Bob will pay 10% to the society at the end of that month. Equally so, if you visit him to view his stock and purchase, Bob will pay 10% of it to the society.

The 'foreword' to his catalogues tells that any orders valued at £40 or more will be offered at minus 30% off the catalogues price, and those who visit his Blackpool warehouse will receive more than 30% off some of his stock, some of which has not been included in the catalogues.

Bob intends to continue searching for books which his customers have informed him that they seek, so even if you do not make a purchase, you can ask him to look out for particular books.

Bob can be contacted by e-mail (preferred) – (landypublishing@yahoo.co.uk) or phone (01253 886103 or 07749838444) by post to 3 Staining Rise, Staining, Blackpool FY3 0BU

---

## THE IRETONS OF ENGLAND

A comprehensive family history in twelve volumes (around 4000 pages) of the Ireton family is available **free of charge – postage only** – to anyone interested in this substantial family name history.

Please contact: [ian.white4@live.co.uk](mailto:ian.white4@live.co.uk) or Tel: 01772 816841

---

## NEW ENGLISH PARISH RECORDS ADDED TO FAMILY SEARCH

Cumbria Parish Registers, 1538-1990

Derbyshire, Church of England Parish Registers, 1537-1918

Devon, Plymouth Prison Records, 1821-1919

Essex Non-Conformist Church Records, 1613-1971

Essex Parish Registers, 1538-1997

Gloucestershire Non-Conformist Church Records, 1642-1996

Index to Register of Passport Applications, 1851-1903

**Lancashire Non-Conformist Church Records, 1647-1996**

Middlesex Parish Registers, 1539-1988  
Northumberland Non-Conformist Church Records, 1613-1920  
Surrey Parish Registers, 1536-1992  
Yorkshire Marriage Bonds and Allegations, 1613-1887

---

## **130 PEDIGREES THAT MAY HELP YOU KICK START YOUR RESEARCH**

Lancashire Archives has two boxes of Pedigree Charts called "Stemmata Varia" in the Search Room (reference LG17/STE) which cover about 130 family names for various time periods.

If you are researching any of the following names it may be worth visiting the Archives when they re-open and seeing if any of these Pedigrees can help you break down a few brick walls.

### **Box 1**

Ashworth, Assheton, Audland, Banastre, Barrow, Batty (see also Redman), Beever, Bell, Bleackley, Blundell, Bold, Boothman, Bradshaw, Bourne, Burman, Calvert, Carr (see Standish), Chamber, Charnock, Chorlton, Clampham, Clarke, Clifton, Cottam, Critchley, Cronshaw, Cross, Cumpsty, Derby (see Lathom), Dickinson, Duckworth, Dugdale, Edleston, Eltoft, English, Farington/Farrington, Fitzhugh (see also Redman), Fitzwilliams, Forshaw, Fowler, Gerard, Gerrard, Girton, Gornall, Grayston, Greenhalgh, Haigh, Hall (see Standish), Hallam (see Redman), Halliwell, Halsted, Hampson, Hardman, Haydock, Heysham, de Hoghton, Holden, Hopwood, Hornby, Hothersall, Ingleby, Jackson, Jameson, Kayss, Kitson, Knowles.

### **Box 2**

Lancaster, Lathom, (includes also Stanley and Derby), Lawrence, Leeming, Longworth, Lonsdale, MacNeal, Marmion (see Redman), Marsh, Mayer, Miller, Mills, Molyneux, Morris, Nicholls, Norton, O'Donnell, Openshaw, Orred, Osbaldeston, Pacey, Park, Pedder, Penketh, Percival, Prestwich, Porter, Prestige, Procter, Redman (includes Marmion, FitzHugh, Batty and Hallam), Richardson, Ronson, Royds, Sandham,

Scarisbrick, Shepherd-Cross, Shorrocks, Simpson, Sparling, Standish, (includes Carr and Hall), Stanley (see Lathom), Starkie, Starky, Stones, Stopford, Stout, Strangways, Swainson, Taylor, Thornton, Threlfall, Thursby, Travis, Vaudrey, Washington, Warburton, Walton, Watson, Whitlow, Wilson, Winder, Witham, Wood, Worsley, Worthington, Wright, Yates, Yeates.

N.B. Don't forget you will need to obtain the new Archive Card to visit. Sign up online before you go.

You can find more information and sign up at [www.archivescard.co](http://www.archivescard.co)

---

### **FREE IRISH WEBSITE**

For those with Irish connections this may be of interest, and it's free.

[www.irishgenealogy.ie](http://www.irishgenealogy.ie)

---

### **BRANCH NEWS**

#### **BLACKBURN & DARWEN**

Branch e-mail: [blackburn@lfhhs.org.uk](mailto:blackburn@lfhhs.org.uk)

---

#### **BURY**

Branch e-mail: [bury@lfhhs.org.uk](mailto:bury@lfhhs.org.uk)

---

## **CHORLEY**

Secretary: Steve Williams, 24 The Cedars, Eaves Green,  
Chorley PR7 3RH

Tel: 01257 262028 Branch e-mail: chorley@lfhhs.org.uk

Chorley branch has developed a virtual website with lots of helpful tips and information.

Each month we have had an online quiz for the branch. See our virtual branch to see what we have planned for the next few months.

<https://www.lfhhschorleybranch.com/lfhhs-chorley-virtual-branch-all.html>

Submitted by Gwen Pratt

---

## **FYLDE**

Secretary: Mrs. Olive Thexton, 7 Bispham Lodge, 251  
Norbreck Road, Thornton Cleveleys FY5 1PE

Branch e-mail: fylde@lfhhs.org.uk

---

## **HERALDRY GROUP**

We normally have a speaker from our own members, low key with any questions answered and finishing about 9.00pm. Help or guidance is available at all our meetings.

---

## **HYNDBURN**

(covering Accrington, Altham, Church, Clayton le Moors, Gt Harwood, Oswaldtwistle & Rishton)

Secretary: Eileen Bullock, 51 Hawthorn Avenue,  
Oswaldtwistle,

Accrington. Lancs BB5 3AE

Branch e-mail: Hyndburn@lfhhs.org.uk

---

## **IRISH ANCESTRY GROUP**

Branch e-mail: [irish@lfhhs.org.uk](mailto:irish@lfhhs.org.uk)

---

### **LANCASTER & MORECAMBE**

Morecambe Heritage Centre, Unit 29 Arndale Centre,  
Morecambe LA4 5DH  
Branch e-mail: [lancaster@lfhhs.org.uk](mailto:lancaster@lfhhs.org.uk)  
Tel: 07462 148067

---

### **LONDON & SOUTH**

Branch e-mail: [london2@lfhhs.org.uk](mailto:london2@lfhhs.org.uk)  
Saint Stephen's Church Hall,  
48 Emperors Gate,  
Kensington  
London SW7 4HJ

### **Joint Cumbria/Lancashire/Cheshire/London & South Branch Report**

After our successful virtual meeting in August we arranged for the next meeting on 31 October to also be held online. Gill Blanchard talked about 'The 1910-1915 Farm Survey and the National Farm Survey 1941-1943'. Gill considers these surveys to be a valuable yet underused resource. They are especially useful for looking into local history and one-place studies but people do not always realise that they can be a good source for family history. You cannot do family history without looking further into your ancestors' lives and these surveys give a fantastic glimpse into people's rural lives. The Inland Revenue Valuation Survey, also known as the Lloyd George Domesday Survey, was started in 1910 and finished in 1920. Its purpose was to raise revenue for the new Pensions Act and National Insurance Act. It was a review of land and property including private homes. Three documents were completed: The



Valuation Register, including details of ownership and rateable values; two copies of coded and annotated Ordnance Survey Maps; and the Field Book. Surviving copies of the Map and the Register are held at County Archive Offices. Generally, the map was a revised copy of the 1901 Ordnance Survey map. The assessment number for each property is essential to find the paperwork. This was usually handwritten on the map in bold, coloured ink. The second copy of the Map, if it has survived, and the Field Books are held at The National Archives (TNA). The Field Book can give you a glimpse not just into the life of an ancestor but also the inhabitants of a village or place where they lived. It provides detailed information which may include the last purchase date and a description of the buildings. The 1943 National Farm Survey is even less well used for research than the 1910 survey. It was compiled from 4 June 1941 by the farmers of agricultural holdings, including piggeries, fruit farms and market gardens, greater than five acres and it took more than two years to complete the survey. Although there are no personal names there could be interesting information about the area. For example, there may be reference to the Women's Land Army. The numbers of male and female workers were recorded, and it indicated if they were related to the farmer. The National Farm Survey is held at the TNA but you should also look at newspapers for reports on the survey. They are filed by parish name. Each holding has a unique reference including letters for the county and parish. They were graded: A = well managed, B = fairly well managed, C = badly managed. If they were badly run the farmer could be replaced, even if he was the owner.

We do not yet have our next meeting arranged but I expect that again it will be held online, using Zoom. Is there a talk or a speaker which you would like to hear which you think would be of interest to the North West Group of Family History Societies? Would you like to give a presentation yourself? We also need people to join the committee, bringing new ideas and to help in organising the talks. Please contact me at the e-mail address below if you have suggestions for future talks or if you would be willing to help with organisation. I am looking forward

to when we can meet again in person but until then we will continue to hold our meetings on a virtual platform. An e-mail will be sent out when we have details of future online talks, and we will post updates on the Society's website and in our Facebook Group. I hope we will be able to meet again sometime during 2021. When we can, talks will take place at St Stephen's Church Hall, 48 Emperor's Gate, Kensington, SW7 4HJ. Bus routes 49 and 74 run along the A4 and there is street parking which is free after 1.30. It is a 5-minute walk from Gloucester Road tube station which is on the Circle, District and Piccadilly Lines. When you leave the tube station walk to the A4 (Cromwell Road) and cross over to the opposite side. Turn left and, staying on the A4, walk to Grenville Place, the first turn on the right. Don't take the first left into Emperor's Gate but continue walking past three houses and take the second turning on the left. You will find St Stephen's Hall a few hundred yards on the right, immediately after the 'Centre for Health'.

Submitted by Helen Conchar, Member 7279  
E-mail: london@cumbriafhs.com

---

### **PENDLE & BURNLEY**

Web site: [www.lfhhs-pendleandburnley.org.uk](http://www.lfhhs-pendleandburnley.org.uk)  
Branch e-mail: [pendle@lfhhs.org.uk](mailto:pendle@lfhhs.org.uk)

---

### **PRESTON**

Secretary: Stewart McLoughlin, 4 Dudley Close, Longton,  
Preston, Lancs PR4 5WH Tel: 01772 614457  
Branch e-mail: [preston@lfhhs.org.uk](mailto:preston@lfhhs.org.uk)

---

## **ROCHDALE**

Secretary: Mrs. Rosemary Fitton, 13 Bowlers Walk, Rochdale.  
Lancs OL12 6EN

Tel: 01706 – 356135 Branch e-mail: rochdale@lfhhs.org.uk

Happy New Year to all our members and friends. I hope you have all managed to keep safe and well during the last twelve months. It is nearly a year since we have been able to hold a branch meeting at Rochdale; we are looking forward to being able to meet up again and will notify members when this is possible. We will of course not do so until we are sure it is ok and safe to do so.

Hopefully by the time you read this, things will have improved and life will be getting back to some sort of normality. My sympathy goes to all those who have lost loved ones and friends during the Covid 19 crisis. It has been a very difficult year and I hope 2021 will be a better one for everyone. Keep safe and well.

---

## **ROSSENDALE**

Branch e-mail: rossendale@lfhhs.org.uk

---

**PLEASE NOTE: THE DEADLINE FOR NEWS FOR THE  
MAY MAGAZINE IS : 23 MARCH 2021  
THANK YOU**

---

## MEMBERS' INTERESTS

### Abbreviations:

- c.Bury = Bury area
- e.20C = early 20th century
- m.18C = mid 18th century
- c.1650 = about 1650
- e.1763 = earliest ancestral link
- l.19C = late 19th century

N.B. The 19th Century ran from 1801 to 1900. Unless otherwise specified, all locality names are in the pre- 1974 County of Lancashire. All other references are to pre- 1974 Counties.

---

**Mrs D. Roberts** (9566) Rose Marie, Main Road,  
Potterhanworth, Lincoln. Lincolnshire LN4 2DT  
Tel: 01522 797905 E-mail: doreenaroberts@btinternet.com

ALSTON	YKS	c.Waddington	pre 1800
BARHOUSE	YKS	c.Giggleswick	pre 1700
BARRAS	YKS	c.Giggleswick	pre 1700
BARNES	LAN	Haslingden	pre 1850
BATTERSBY	LAN	Slaidburn	pre 1750
BORDLEY	YKS	Giggleswick, Wigglesworth, Rathmell Tosside, Gisburn Forest,	1500-1800
BRIGGS	YKS	Gisburn Forest Grindleton	pre 1700 pre 1900
BUTTERWORTH	YKS	Wigglesworth	pre 1700
CAMBE/CAMM	YKS	Slaidburn, Gisburn Forest, Bolton by Bowland	17C-19C
CAWLEY	CHS	c.Little Budworth	pre 1820
CHATBURN	LAN	Chatburn, Downham, Rimington	16C+

CLARK(E)	YKS	Halton West, Wigglesworth Gisburn Forest Gisburn, c.Tosside c.Bolton by Bowland	16C-17C 16C+ 17C+ 17C+ 17C+
CLARK(E)	LAN	Clitheroe c.Hellifield	19C+ 1700-1800
COAT(E)S	YKS	Bolton by Bowland	pre 1750
COOK(E)	YKS	Halton West, Wigglesworth, Long Preston	16C-17C
C(O)UNDEL	YKS	Settle	pre 1750
DAY	YKS	Slaidburn, Long Preston	pre 1700
DUCKET(T)	CUL	Sedbergh	16C
DUCKET(T)	YKS	c.Wigglesworth	16C-18C
DUGDALE	YKS	Gisburn Forest	17C
EGLIN	YKS	c.Long Preston, c.Wigglesworth, Gisburn Forest	pre 1750
ELKIN	STS	c.Trentham	pre1800
ELLIL	YKS	Bolton by Bowland	pre 1570
ELLIS	YKS	Gisburn Forest	pre 1750
FARRAR	LAN	Burnley	16C-17C
FARRAR	LAN	Downham	17C
FELL	YKS	Waddington, West Bradford, Slaidburn, Tosside	17C-19C
GELDARD	YKS	c.Gisburn Forest, c.Bolton by Bowland	16C+
GIRLINGTON	CUL	Sedbergh	16C
GLEAVE	CHS	c.Tarvin	pre 1820
GREEN	YKS	c.Skipton	pre 1700
GREENWOOD	YKS	c.Long Preston	pre 1780
HARGREAVES	YKS	Bolton by Bowland	pre 1800
HARRISON	YKS	Gisburn Forest	17C+
HARRISON	YKS	c.Grindleton	pre 1900
HARTLEY	YKS	Haworth	pre 1820
HILDITCH	STS	Audley	pre 1850
HOLDEN	LAN	Haslingden	pre 1850
HOLDEN	LAN	Blackburn	1850-1900

HOLDEN	LAN	Clitheroe	c1880-1950
HOLDEN	YKS	c.Gisburn Forest	pre 1800
HOULDEN	YKS	Slaidburn	17C
ISHERWOOD	YKS	Bolton by Bowland, Gisburn	pre 1830
KNOWLES	YKS	c.Long Preston, c.Giggleswick. Settle, c.Rathmell	pre 1700
LACHE/LEAKE/	YKS	Wigglesworth	pre 1700
LETCH	YKS	Wigglesworth	pre 1700
LAMBERT	YKS	Kildwick	16C-17C
LAWSON	YKS	c.Settle	16C-18C
LAWTON	STS	c.Keele, c.Audley	pre 1850
LEEMING	YKS	Grindleton	pre 1800
MACHIN	CHS	Monks Coppenhall	1861-1871
MEACHIN	CHS	Monks Coppenhall	1861-1871
MEACHIN	CHS	Altrincham	1871-1881
MEACHIN	LAN	Rishton	1891+
MARSDEN	YKS	c.Wigglesworth	1700-1800
METCALFE	LAN	Clitheroe	pre 1850
NIGHTINGALE	LAN	c.Chorley, c.Leyland	pre1850
NIGHTINGALE	LAN	c.Blackburn	1850+
ODD(IE)/ODDEY/ ODDY/ODDE/ HODDY/HODDIE/ OADE(S)/OATES	YKS	Grindleton, Bolton by Bowland, Gisburn, Martin Top, Rimington, Waddington	pre 1850
PALIN	CHS	Audlem, Wybunbury, Over Peover, Monks Coppenhall	pre 1800
PARCIVAL	YKS	Gisburn	pre 1750

---

**Mr. L. Towers** (9694) Maelor, Manod Road, Bleanau  
Ffestiniog, Gwynedd LL41 4DE Tel: 01766 831376  
E-mail: towersles@hotmail.co.uk

TOWERS	LAN	Wrey	1700-1800
--------	-----	------	-----------

---

**Mr. D. H. Smith** (10416) P. O. Box 350951, Palm Coast,  
32135-095 USA E-mail: dhsmith744@gmail.com  
HARDMAN LAN Rochdale 1600-1700

---

**Mr. J. Gee** (10666) 21 Congleton Road, Alderley Edge,  
Cheshire SK8 7AE E-mail: jimgee.ae@gmail.com  
CHADWICK LAN Bury c1800  
GEE LAN Bury (Print Cutter) c1800

---

**Mrs. H. Bellamy** (10775) 64 Salisbury Road, Barry, Vale of  
Glamorgan CF62 6PD Tel: 01446 404857  
E-mail: r.h.bellamy@ntlworld.com  
BARNES LAN Warrington 1650-1850  
MAMON LAN Ribchester 1730-1800  
MARSDEN LAN Colne 1750-1820  
ROBINSON LAN Garstang 1750-1850  
WALSH LAN Blackburn 1780-1900  
YATES LAN St. Helens 1750-1850  
YATES LAN Farnworth 1780-1850  
WALSH LAN Darwen 1780-1900

---

**Mr. M. N. Holmes** (10942) P.O. Box 680, Nelson Bay, New  
South Wales 2315 Australia  
E-mail: holmes-oakendale@hotmail.com  
HULMES LAN Manchester  
(Cordwainer/Bootmaker)1700-1880

---

**Mrs. S. Waddington and Mr. J. Waddington** (10970)  
16 Waterloo Road, Wokingham, Berkshire RG40 2JH  
E-mail: susan.waddington@gmail.com  
SANDIFORD LAN (Calico printers)

---

**Mr. N. Whittaker** (11059) 46 E Placita Vista Campo,  
Sahuarita AZ 85629 USA E-mail: neilw3d@gmail.com  
MERRILL LAN Accrington 1851-1900

SOLLY	LAN	Rochdale (Nurse)	1902-1911
WHITTAKER	LAN	Rochdale (Florist)	1850+

---

**Mrs. C. E. Barr** (11098) 10 Ridgeway Cliff, Herne Bay, Kent  
CT6 8JQ E-mail: chrissiebarr@me.com

HALL	LAN	Warrington (Travelling showman)	1850-1900
------	-----	------------------------------------	-----------

---

**Mr. C. Godfrey** (11112) 23 Newall Street, Littleborough,  
Lancashire OL15 9DL E-mail: uthred85@gmail.com

GODFREY	MDX	Pimlico (Gunsmiths)	17C-18C
WILD(E)	LAN	Wardle, Rochdale	18C-19C

---

**Mr. I. Benbow** (11113) 26 Hawthorn Road, Bolton le Sands,  
Carnforth, Lancashire LA5 8EH E-mail: iantb54@hotmail.com

BENBOW	LAN		
--------	-----	--	--

---

**Mr. M. Lee** (11114) Aeussere Baselstrasse 159, Riehen, 4125  
Switzerland. E-mail: michaellee77@gmail.com

BENTLEY	LAN	Brightmet, Elton	1800-1850
BIRCHALL	LAN	Liverpool	1830-1850
BROMLEY	LAN	Harwood, Turton	1860-1900
DOHERTY	LAN	Salford, Hulme	1835-1910
DONNELLY	LAN	Salford	1810-1850
FOWLER	LAN	Leyland, Chorley	1810-1850
GILLETT	LAN	Kirkham, Chorley	1810-1920
HULL	LAN	Singleton	1815
KERFOOT	LAN	Chorley	1840-1910
KERSHAW	LAN	Turton	1790-1870
LEE	LAN	Harwood	1800+
MOSS	LAN	Preston, Chorley	1830-1940
MURRAY	ARM	Seagoe	1809-1828
NOBLE	AYR	Tarbolton, Alloway	1700-1800
ORMROD	LAN	Brightmet, Harwood	1800-1910
PARTINGTON	LAN	Leyland	1820-1850
PLATT	LAN	Bradshaw	1700-1850



RAMSDEN	LAN	Bolton	1780-1850
ROBINSON	LAN	Liverpool	1830-1850
SCOWCROFT	LAN	Bolton, Harwood	1800-1900
SPENCER	LAN	Brightmet	1750-1800
STEPHENSON	LAN	Blackburn	1800-1850
TAYLOR	LAN	Sharples	1800-1900
THORNLEY	LAN	Leyland, Chorley	1810-1840
TOMLINSON	LAN	Chorley	1820-1840
WARING	LAN	Chorley	1810-1860
WHALLEY	LAN	Preston	1820-1870

---

**Ms. A. Mackintosh** (11115) 21 Churchill Road, Judea,  
Tauranga, 3110 New Zealand E-mail: amacgvs@gmail.com

ALDIE	ANS	Lintrathen, Kirriemuir, Forfar	18C-20C
ALDIE	NZL		18C-20C
ALLARDICE	ANS	Glamis, Kirriemuir, Forfar	18C-20C
ALLARDICE	NZL	Gore, Wellington	18C-20C
ALLEN	CON	St. Mewan	18C-19C
ANDERSON	ANS	Dundee, Forfar	18C-20C
BRIGGS	LAN	Clitheroe	18C
BRYANT	WIL	Chippenham, Bath	18C-20C
BRYANT	NZL		18C-20C
CALVERT	LAN	Great Harwood	18C-19C
CHRISTIE	ANS	Forfar	18C-19C
CLARK	DBY	Edensor	19C
CLARK	LAN	Ramsbottom	19C
COCKROFT	LAN		17C
DEAN	LAN	Whalley	17C-18C
EVANS	PEM	Pembroke	18C-19C
EVANS	SOM	Failand	18C-19C
EXTON	LAN	Whalley	17C-19C
FEARNSIDE	LAN	Whalley	18C
GREENAWAY	WIL	Caine, Chippenham	18C-19C
GRIMSHAW	LAN	Blackburn, Bury, Great Harwood	18C-19C
HARGREAVES	LAN	Clitheroe	18C

HIGGINSON	LAN		18C-19C
HUTCHISON	ANS	Inverairity, Nethy, Forfar	19C-20C
JELLY	SOM	Failand, Bath	19C-20C
MACKINTOSH	INV	Daviot, Linreoch, Inverness	12C-20C
MACKINTOSH	ANS	Forfar	12C-20C
MACKINTOSH	NZL		12C-20C
MONCUR	ANS	Kirriemuir	17C-18C
MORRIS	LAN	Whalley	17C
ODDIE	YKS		18C
REDMAN	LAN	Whalley	17C
SMART	ANS	Lintrathen	17C-18C
STRONGMAN	CON	St. Austell, St. Mewan. St. Day	18C-20C
STRONGMAN	AUS		18C-20C
SUTCLIFFE	LAN	Whalley, Pendleton, Wiswell, Ramsbottom, Tottington Lower End, Bury, Blackburn	16C-20C
SUTCLIFFE	AUS	Ballarat, Clunes	16C-20C
SUTCLIFFE	NZL	Christchurch, Temuka, Te Kuiti, Eltham	16C-20C
TREVERTON	CON	St. Stephens in Brannell, St. Mewan	18C-19C
VIVIAN	CON	Trelowarren, Cambourne, St. Austell, St. Mewan	15C-19C
VIVIAN	AUS		15C-19C
WIDDOP	LAN		16C-20C

---

**Mr. O. Hartley**, (11139) Annandale, Dunction, Petworth,  
West Sussex GU28 0LB E-mail: [oliver.hartley@btinternet.com](mailto:oliver.hartley@btinternet.com)

HARTLEY	LAN	Colne	18C-20C
LONSDALE	LAN	Colne	18C-20C
WHIT(T)AKER	LAN	Colne	18C-20C

---

**TAKE CARE AND STAY SAFE EVERYONE!**

**THE LANCASHIRE FAMILY HISTORY AND HERALDRY SOCIETY  
CONTACTS**

- Chairman:** **Sheila COURT**, Flat 3, 51 West End Road, Morecambe LA4 4DR  
Tel: 01524 411439 [chairman@lfhhs.org.uk](mailto:chairman@lfhhs.org.uk)
- Treasurer:** **Ian White**, 23 School Fold, Hesketh Bank, West Lancs PR4 6RE  
Tel: 01772 816841 [treasurer@lfhhs.org.uk](mailto:treasurer@lfhhs.org.uk)
- Membership Secretary – for Subscriptions and Renewals:**  
**Sue FOSTER**, 18 Glencross Place, BLACKPOOL FY4 5AD  
Tel: 01253 694783 [membership@lfhhs.org.uk](mailto:membership@lfhhs.org.uk)
- Editor – for Articles, Notes & News and items for the Journal:**  
**Hazel JOHNSON**, 65 Lever House Lane, LEYLAND PR25 4XN  
Tel: 01772 513618 [hazel.johnson2@btopenworld.com](mailto:hazel.johnson2@btopenworld.com)  
Or [editor@lfhhs.org.uk](mailto:editor@lfhhs.org.uk)
- Pedigree Database** **David BRETHERTON**, 33 Towersey Drive, THAME OX9 3NR  
Tel: 01844 215178 [pedigrees@lfhhs.org.uk](mailto:pedigrees@lfhhs.org.uk)
- Surname Interests** **Jennifer BENSON**, 32 Slater Lane, LEYLAND PR25 1TN  
Tel: 01772 422808 [surnames@lfhhs.org.uk](mailto:surnames@lfhhs.org.uk)
- Helping Hands & Mentoring** **Fiona HALL**, 6 Willowherb Close, Prestbury, CHELTENHAM GL52 5LP  
[help@lfhhs.org.uk](mailto:help@lfhhs.org.uk)
- Projects:** **Tony FOSTER**, 142 Cotswold Crescent, BURY BL8 1QP  
[projects@lfhhs.org.uk](mailto:projects@lfhhs.org.uk)
- Sales:** Sales Officer, 2 Straits, Oswaldtwistle, ACCRINGTON BB5 3LU  
[sales@lfhhs.co.uk](mailto:sales@lfhhs.co.uk)
- Heraldry:** **Chris WARD**  
[heraldry@lfhhs.org.uk](mailto:heraldry@lfhhs.org.uk)
- Education Liaison:** **Mike COYLE**, 248 Hawes Side Lane, BLACKPOOL FY4 5AH  
Tel: 01253 761778 [education@lfhhs.org.uk](mailto:education@lfhhs.org.uk)
- Webmaster:** **Stephen BENSON**, 32 Slater Lane, LEYLAND PR25 1TN  
Tel: 01772 422808 [webmaster@lfhhs.org.uk](mailto:webmaster@lfhhs.org.uk)
- Research Centre:** 2 Straits, Oswaldtwistle, ACCRINGTON BB5 3LU  
Tel: 01254 239919 (Answerphone)  
For opening times see [www.lfhhs.org.uk](http://www.lfhhs.org.uk)

**PLEASE NOTE:**

It is regretted that requests for searches of ALL ONE SURNAME cannot be undertaken. Where a reply is required please enclose a stamped addressed envelope (or 3 IRC coupons). Changes of address and non-receipt of journals should be reported to **Membership Secretary**, 18 Glencross Place, Blackpool FY4 5AD. If you are aware of the death of any member kindly advise **Sue Foster** who will ensure that future magazines are not sent out. Thank you.

**LANCASHIRE FAMILY HISTORY & HERALDRY SOCIETY**

**\*\* IMPORTANT \*\***

**Are your membership details up to date?**

**Have you changed your email address?**

This year we have had a larger than usual number of emails returned as the email address is no longer valid. Members with an email address should receive confirmation when they join or renew their membership. If you have not received this email, it is likely that we do not have your correct email address on record. This applies particularly to members who pay their subscription by standing order.

Please let us know any change of email address or any other personal contact details to:

Sue Foster, Membership Secretary

Email: [membership@lfhhs.org.uk](mailto:membership@lfhhs.org.uk)

Text: 07963 132979

Address: 18 Glencross Place, Blackpool FY4 5AD

Telephone: 01253 694783 (leave a message and phone number, please)